

mdf italia



© COPYRIGHT 2019 MDF ITALIA SRL SOCIETA' UNIPERSONALE

2017

COSY LOW TABLE 1 - 2

Designed by Francesco Rota

Cosy low table 1 and Cosy low table 2 are coffee table sets designed in large sizes; small architectural solutions with strictly rigorous lines. They also offer low parts for storage.

Piece of accessory that contrasts with the soft volumes of the padded items to underscore their functional features for MDF Italia's living-room.

[Discover also Cosy sofa. Click here](#)

STRUCTURE AND FINISH

Cosy Low Table 1 produced in curved aluminium, thickness 6mm, matt painted with epoxy powders in the colours white or graphite grey.

Cosy Low Table 2 made of high-pressure stratified laminate FENIX NTM matt, thickness 10 mm, in the colours white or black.

Open compartment with top tray in medium density fibreboard, thickness 8mm, micro goffered lacquered in matt medium grey or matt turtledove grey.

COSY LOW TABLE 1

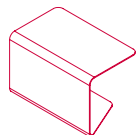

L65.6 D40 H43 cm

COSY LOW TABLE 2

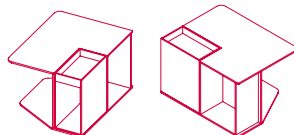

L70.6 D55 H43 cm

Finishing

The number in the dot corresponds to the number of colour/material finish.

Here below, in the section FINISH OPTIONS, please note all the colours of the materials used for this product.

COSY LOW TABLE 1

Structure

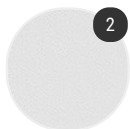

Matt painted

COSY LOW TABLE 2

Structure



Structure

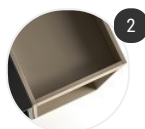

Open compartment

Finish options

STRUCTURE

Matt painted



Matt painted
white X053



Matt painted
graphite grey
X054

Structure



Fenix matt
white X020

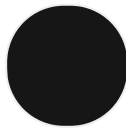

Fenix matt
black X022

Open compartment

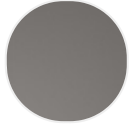

Matt
lacquered
medium grey
X093



Matt
lacquered
turtledove